

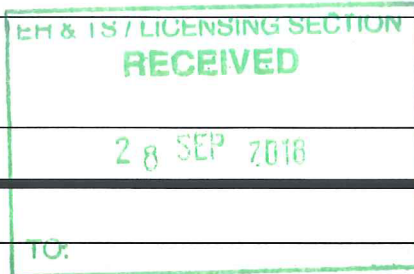

**Herefordshire**  
**Application for a premises licence**  
**Licensing Act 2003**



For help contact  
[licensing@herefordshire.gov.uk](mailto:licensing@herefordshire.gov.uk)  
 Telephone: 01432 261761

\* required information

**Form errors**

Some data entered into this form is invalid. Please resolve before continuing.

**Section 1 of 21**

You can save the form at any time and resume it later. You do not need to be logged in when you resume.

System reference

Not Currently In Use

This is the unique reference for this application generated by the system.

Your reference

Forge Alcohol Licence

You can put what you want here to help you track applications if you make lots of them. It is passed to the authority.

Are you an agent acting on behalf of the applicant?

Yes  No

Put "no" if you are applying on your own behalf or on behalf of a business you own or work for.

**Applicant Details**

\* First name

Karl

\* Family name

Hawkins

\* E-mail

Forgefillingstation@gmail.com

Main telephone number

[REDACTED]

Include country code.

Other telephone number

Indicate here if you would prefer not to be contacted by telephone

Are you:

- Applying as a business or organisation, including as a sole trader  
 Applying as an individual

A sole trader is a business owned by one person without any special legal structure. Applying as an individual means you are applying so you can be employed, or for some other personal reason, such as following a hobby.

**Applicant Business**

Is your business registered in the UK with Companies House?

Yes  No

Note: completing the Applicant Business section is optional in this form.

Registration number

11240633

Business name

Forge Filling Station

If your business is registered, use its registered name.

VAT number

GB 291226116

Put "none" if you are not registered for VAT.

Continued from previous page...

Legal status

Your position in the business

Home country  The country where the headquarters of your business is located.

**Registered Address**

Address registered with Companies House.

Building number or name

Street

District

City or town

County or administrative area

Postcode

Country



**Section 2 of 21**

**PREMISES DETAILS**

I/we, as named in section 1, apply for a premises licence under section 17 of the Licensing Act 2003 for the premises described in section 2 below (the premises) and I/we are making this application to you as the relevant licensing authority in accordance with section 12 of the Licensing Act 2003.

**Premises Address**

Are you able to provide a postal address, OS map reference or description of the premises?

- Address     OS map reference     Description

**Postal Address Of Premises**

Building number or name

Street

District

City or town

County or administrative area

Postcode

Country

**Further Details**

Telephone number

Non-domestic rateable  
value of premises (£)

8,400

### Section 3 of 21

#### APPLICATION DETAILS

In what capacity are you applying for the premises licence?

- An individual or individuals
- A limited company / limited liability partnership
- A partnership (other than limited liability)
- An unincorporated association
- Other (for example a statutory corporation)
- A recognised club
- A charity
- The proprietor of an educational establishment
- A health service body
- A person who is registered under part 2 of the Care Standards Act 2000 (c14) in respect of an independent hospital in Wales
- A person who is registered under Chapter 2 of Part 1 of the Health and Social Care Act 2008 in respect of the carrying on of a regulated activity (within the meaning of that Part) in an independent hospital in England
- The chief officer of police of a police force in England and Wales

#### Confirm The Following

- I am carrying on or proposing to carry on a business which involves the use of the premises for licensable activities
- I am making the application pursuant to a statutory function
- I am making the application pursuant to a function discharged by virtue of Her Majesty's prerogative

### Section 4 of 21

#### INDIVIDUAL APPLICANT DETAILS

##### Applicant Name

Is the name the same as (or similar to) the details given in section one?

- Yes  No

If "Yes" is selected you can re-use the details from section one, or amend them as required. Select "No" to enter a completely new set of details.

First name

Karl

Family name

Hawkins

Continued from previous page...

Is the applicant 18 years of age or older?

Yes  No

**Current Residential Address**

Is the address the same as (or similar to) the address given in section one?

Yes  No

If "Yes" is selected you can re-use the details from section one, or amend them as required. Select "No" to enter a completely new set of details.

Building number or name  
Street  
District  
City or town  
County or administrative area  
Postcode  
Country

**Applicant Contact Details**

Are the contact details the same as (or similar to) those given in section one?

Yes  No

If "Yes" is selected you can re-use the details from section one, or amend them as required. Select "No" to enter a completely new set of details.

E-mail  
Telephone number  
Other telephone number  
\* Date of birth

dd mm yyyy

\* Nationality

Welsh

[Documents that demonstrate entitlement to work in the UK](#)

Add another applicant

**Section 5 of 21**

**OPERATING SCHEDULE**

When do you want the premises licence to start?

/  /   
dd mm yyyy

If you wish the licence to be valid only for a limited period, when do you want it to end

/  /   
dd mm yyyy

Provide a general description of the premises



Continued from previous page...

For example the type of premises, its general situation and layout and any other information which could be relevant to the licensing objectives. Where your application includes off-supplies of alcohol and you intend to provide a place for consumption of these off- supplies you must include a description of where the place will be and its proximity to the premises.

Rural Petrol Station serving fuel and groceries, animal feeds, livestock feeds, coal, etc. Established for almost 50 years with the business hours of 6.30 am until 9.30 pm. Alcohol will only be sold on an off-licence basis, but still be part of the petrol station shop and goods stored in the same area.

If 5,000 or more people are expected to attend the premises at any one time, state the number expected to attend

0

### Section 6 of 21

#### PROVISION OF PLAYS

[See guidance on regulated entertainment](#)

Will you be providing plays?

Yes  No

### Section 7 of 21

#### PROVISION OF FILMS

[See guidance on regulated entertainment](#)

Will you be providing films?

Yes  No

### Section 8 of 21

#### PROVISION OF INDOOR SPORTING EVENTS

[See guidance on regulated entertainment](#)

Will you be providing indoor sporting events?

Yes  No

### Section 9 of 21

#### PROVISION OF BOXING OR WRESTLING ENTERTAINMENTS

[See guidance on regulated entertainment](#)

Will you be providing boxing or wrestling entertainments?

Yes  No

### Section 10 of 21

#### PROVISION OF LIVE MUSIC

[See guidance on regulated entertainment](#)

Will you be providing live music?

Yes  No

### Section 11 of 21

#### PROVISION OF RECORDED MUSIC

Continued from previous page...

Will you be providing recorded music?

Yes  No

**Section 12 of 21**

**PROVISION OF PERFORMANCES OF DANCE**

[See guidance on regulated entertainment](#)

Will you be providing performances of dance?

Yes  No

**Section 13 of 21**

**PROVISION OF ANYTHING OF A SIMILAR DESCRIPTION TO LIVE MUSIC, RECORDED MUSIC OR PERFORMANCES OF DANCE**

[See guidance on regulated entertainment](#)

Will you be providing anything similar to live music, recorded music or performances of dance?

Yes  No

**Section 14 of 21**

**LATE NIGHT REFRESHMENT**

Will you be providing late night refreshment?

Yes  No

**Section 15 of 21**

**SUPPLY OF ALCOHOL**

Will you be selling or supplying alcohol?

Yes  No

**Standard Days And Timings**

MONDAY

Start

End

Start

End

TUESDAY

Start

End

Start

End

WEDNESDAY

Start

End

Start

End

THURSDAY

Start

End

Start

End

Give timings in 24 hour clock.  
(e.g., 16:00) and only give details for the days  
of the week when you intend the premises  
to be used for the activity.

Continued from previous page...

FRIDAY

Start  End   
Start  End

SATURDAY

Start  End   
Start  End

SUNDAY

Start  End   
Start  End

Will the sale of alcohol be for consumption:

- On the premises     Off the premises     Both

If the sale of alcohol is for consumption on the premises select on, if the sale of alcohol is for consumption away from the premises select off. If the sale of alcohol is for consumption on the premises and away from the premises select both.

State any seasonal variations

For example (but not exclusively) where the activity will occur on additional days during the summer months.

none

Non-standard timings. Where the premises will be used for the supply of alcohol at different times from those listed in the column on the left, list below

For example (but not exclusively), where you wish the activity to go on longer on a particular day e.g. Christmas Eve.

none

State the name and details of the individual whom you wish to specify on the licence as premises supervisor

**Name**

First name

Family name

Date of birth   
dd mm yyyy

Continued from previous page...

**Enter the contact's address**

Building number or name  
Street  
District  
City or town  
County or administrative area  
Postcode  
Country  
Personal Licence number  
(if known)

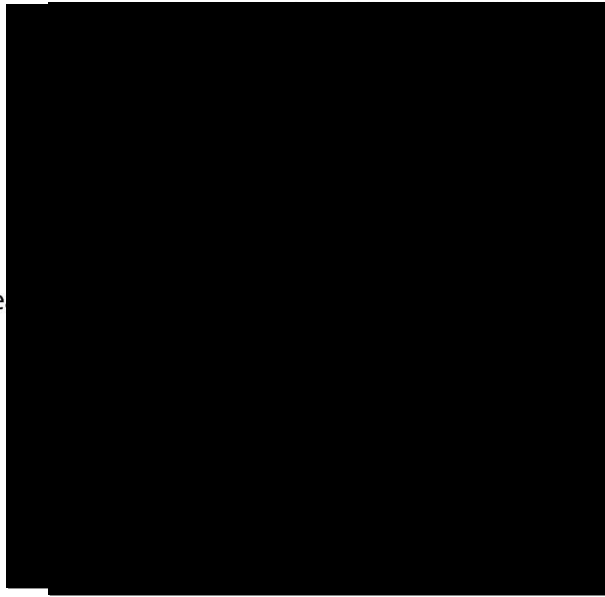

Issuing licensing authority  
(if known)

Trofaen

**PROPOSED DESIGNATED PREMISES SUPERVISOR CONSENT**

How will the consent form of the proposed designated premises supervisor be supplied to the authority?

- Electronically, by the proposed designated premises supervisor
- As an attachment to this application

Reference number for consent form (if known)

forgesupervisor2018

If the consent form is already submitted, ask the proposed designated premises supervisor for its 'system reference' or 'your reference'.

**Section 16 of 21**

**ADULT ENTERTAINMENT**

Highlight any adult entertainment or services, activities, or other entertainment or matters ancillary to the use of the premises that may give rise to concern in respect of children

Give information about anything intended to occur at the premises or ancillary to the use of the premises which may give rise to concern in respect of children, regardless of whether you intend children to have access to the premises, for example (but not exclusively) nudity or semi-nudity, films for restricted age groups etc gambling machines etc.

none

**Section 17 of 21**

**HOURS PREMISES ARE OPEN TO THE PUBLIC**

**Standard Days And Timings**



Continued from previous page...

MONDAY

Start

End

Give timings in 24 hour clock.  
(e.g., 16:00) and only give details for the days  
of the week when you intend the premises  
to be used for the activity.

Start

End

TUESDAY

Start

End

Start

End

WEDNESDAY

Start

End

Start

End

THURSDAY

Start

End

Start

End

FRIDAY

Start

End

Start

End

SATURDAY

Start

End

Start

End

SUNDAY

Start

End

Start

End

State any seasonal variations

For example (but not exclusively) where the activity will occur on additional days during the summer months.

none

Non standard timings. Where you intend to use the premises to be open to the members and guests at different times from those listed in the column on the left, list below

For example (but not exclusively), where you wish the activity to go on longer on a particular day e.g. Christmas Eve.

none

Section 18 of 21

LICENSING OBJECTIVES

Describe the steps you intend to take to promote the four licensing objectives:

a) General – all four licensing objectives (b,c,d,e)

List here steps you will take to promote all four licensing objectives together.

Strong management controls and effective training of all staff so that they are aware of the premises licence and the requirements to meet the four licensing objectives with particular attention to:

a/ no selling of alcohol to underage people

b/ no drunk and disorderly behavior on the premises area

c/ vigilance in preventing the use and sale of illegal drugs at the retail area

d/ no violent and anti-social behaviour

e/ no any harm to children

- Operating Schedule providing the hours of operation and licensable activities during those hours.

- Designated premises supervisor confirmed it is obligated to be in day-to-day control of the premises, to provide good training for staff on the Licensing Act (Training Record), to make or authorize each sale

- Clear "Challenge 25" information to prevent the supply of alcohol to under-age drinkers.

- CCTV system installed with recording option available

- Roller metal exterior window shutter will be fixed to ensure that shop front is safe and secure at all times

As a licensed premises we know that it is necessary to carry out our functions or operate their businesses with a purpose of promoting these objectives. We promise to support these objectives through their operating schedules and other measures (including staff training and qualifications, policies, and strategic partnerships with other agencies).

b) The prevention of crime and disorder

CCTV System installed to monitor entrances, exits, and other parts of the premises in order to address the prevention of crime objective.

A clear and legible notice outside the premises indicating the normal hours under the terms of the premises licence during which licensable activities are permitted.

Clear and conspicuous notices warning of potential criminal activity, such as theft, that may target customers will be displayed.

Not selling of alcohol to drunk or intoxicated customers.

Custom will not be sought by means of personal solicitation outside or in the vicinity of the premises.

Prevention and vigilance in illegal drug use at the retail unit area.

Staff will be well trained in asking customers to use premises in an orderly and respectful manner and prevent drinking alcohol at the retail unit (ex. canned or bottled beer).

c) Public

c) Public safety

Internal and external lighting fixed to promote the public safety objective.

Well trained staff adherence to environmental health requirements.

Training and implementation of underage ID checks.

A log book or recording system shall be kept upon the premises in which shall be entered particulars of inspections made; those required to be made by statute, and information compiled to comply with any public safety condition attached to the premises licence that requires the recording of such information. The log book shall be kept available for inspection when required by persons authorised by the Licensing Act 2003 or associated legislation.

All parts of the premises and all fittings and apparatus therein, door fastenings and notices, lighting, heating, electrical, air condition, sanitary accommodation and other installations, will be maintained at all times in good order and in a safe condition.

d) The prevention of public nuisance

Noise reduction measures to address the public nuisance objective.

Prominent, clear and legible notices will be displayed at the exit requesting the public to respect the needs of nearby

**Continued from previous page...**

residents and to leave the premises and the area quietly.

Deliveries of goods necessary for the operation of the business will be carried out at such a time or in such a manner as to  
© Queen's Printer and Controller of HMSO 2009

Continued from previous page...

prevent nuisance and disturbance to nearby residents.

The Licensee will ensure that staff who arrive early morning or depart late at night (ex. for unpacking, pricing newly delivered goods) when the business has ceased trading conduct themselves in such a manner to avoid causing disturbance to nearby residents.

Customers will be asked not to stand around loudly talking in the street outside the premises.

Customers will not be admitted to premises above opening hours.

The movement of bins and rubbish outside the premises will be kept to a minimum after 11.00pm. This will help to reduce the levels of noise produced by the premises.

Any lighting on or outside the premises will be positioned and screened in such a way so as to not cause a disturbance to nearby residents.

Adequate waste receptacles for use by customers will be provided in the local vicinity.

e) The protection of children from harm

"Challenge 25" sign which is a retailing strategy that encourages anyone who is over 18 but looks under 25 to carry acceptable ID (a card bearing the PASS hologram, a photographic driving license or a passport) if they wish to buy alcohol.

Well trained staff about requirement for persons' identification, age establishment etc.

All the details provided in Training Record Book available the retail unit.

Log Book will be kept upon the premises all the time.

Nothing belong existing Health & Safety requirements

**Section 19 of 21**

**NOTES ON DEMONSTRATING ENTITLEMENT TO WORK IN THE UK**



---

*Continued from previous page...*

**Entitlement to work/immigration status for individual applicants and applications from partnerships which are not limited liability partnerships:**

A licence may not be held by an individual or an individual in a partnership who is resident in the UK who:

- does not have the right to live and work in the UK; or
- is subject to a condition preventing him or her from doing work relating to the carrying on of a licensable activity.

Any premises licence issued in respect of an application made on or after 6 April 2017 will become invalid if the holder ceases to be entitled to work in the UK.

Applicants must demonstrate that they have an entitlement to work in the UK and are not subject to a condition preventing them from doing work relating to the carrying on of a licensable activity. They do this by providing with this application copies or scanned copies of the following documents (which do not need to be certified).

**Documents which demonstrate entitlement to work in the UK**

- An expired or current passport showing the holder, or a person named in the passport as the child of the holder, is a British citizen or a citizen of the UK and Colonies having the right of abode in the UK [please see note below about which sections of the passport to copy].
  - An expired or current passport or national identity card showing the holder, or a person named in the passport as the child of the holder, is a national of a European Economic Area country or Switzerland.
  - A Registration Certificate or document certifying permanent residence issued by the Home Office to a national of a European Economic Area country or Switzerland.
  - A Permanent Residence Card issued by the Home Office to the family member of a national of a European Economic Area country or Switzerland.
  - A **current** Biometric Immigration Document (Biometric Residence Permit) issued by the Home Office to the holder indicating that the person named is allowed to stay indefinitely in the UK, or has no time limit on their stay in the UK.
  - A **current** passport endorsed to show that the holder is exempt from immigration control, is allowed to stay indefinitely in the UK, has the right of abode in the UK, or has no time limit on their stay in the UK.
  - A **current** Immigration Status Document issued by the Home Office to the holder with an endorsement indicating that the named person is allowed to stay indefinitely in the UK or has no time limit on their stay in the UK, **when produced in combination with** an official document giving the person's permanent National Insurance number and their name issued by a Government agency or a previous employer.
  - A **full** birth or adoption certificate issued in the UK which includes the name(s) of at least one of the holder's parents or adoptive parents, **when produced in combination with** an official document giving the person's permanent National Insurance number and their name issued by a Government agency or a previous employer.
  - A birth or adoption certificate issued in the Channel Islands, the Isle of Man or Ireland **when produced in combination with** an official document giving the person's permanent National Insurance number and their name issued by a Government agency or a previous employer.
  - A certificate of registration or naturalisation as a British citizen, **when produced in combination with** an official document giving the person's permanent National Insurance number and their name issued by a Government agency or a previous employer.
  - A **current** passport endorsed to show that the holder is allowed to stay in the UK and is currently allowed to work and is not subject to a condition preventing the holder from doing work relating to the carrying on of a licensable activity.
-



*Continued from previous page...*

- A **current** Biometric Immigration Document (Biometric Residence Permit) issued by the Home Office to the holder which indicates that the named person can currently stay in the UK and is allowed to work relation to the carrying on of a licensable activity.
- A **current** Residence Card issued by the Home Office to a person who is not a national of a European Economic Area state or Switzerland but who is a family member of such a national or who has derivative rights or residence.
- A **current** Immigration Status Document containing a photograph issued by the Home Office to the holder with an endorsement indicating that the named person may stay in the UK, and is allowed to work and is not subject to a condition preventing the holder from doing work relating to the carrying on of a licensable activity **when produced in combination with** an official document giving the person's permanent National Insurance number and their name issued by a Government agency or a previous employer.
- A Certificate of Application, **less than 6 months old**, issued by the Home Office under regulation 17(3) or 18A (2) of the Immigration (European Economic Area) Regulations 2006, to a person who is not a national of a European Economic Area state or Switzerland but who is a family member of such a national or who has derivative rights of residence.
- Reasonable evidence that the person has an outstanding application to vary their permission to be in the UK with the Home Office such as the Home Office acknowledgement letter or proof of postage evidence, or reasonable evidence that the person has an appeal or administrative review pending on an immigration decision, such as an appeal or administrative review reference number.
- Reasonable evidence that a person who is not a national of a European Economic Area state or Switzerland but who is a family member of such a national or who has derivative rights of residence in exercising treaty rights in the UK including:-
  - evidence of the applicant's own identity – such as a passport,
  - evidence of their relationship with the European Economic Area family member – e.g. a marriage certificate, civil partnership certificate or birth certificate, and
  - evidence that the European Economic Area national has a right of permanent residence in the UK or is one of the following if they have been in the UK for more than 3 months:
    - (i) working e.g. employment contract, wage slips, letter from the employer,
    - (ii) self-employed e.g. contracts, invoices, or audited accounts with a bank,
    - (iii) studying e.g. letter from the school, college or university and evidence of sufficient funds; or
    - (iv) self-sufficient e.g. bank statements.

Family members of European Economic Area nationals who are studying or financially independent must also provide evidence that the European Economic Area national and any family members hold comprehensive sickness insurance in the UK. This can include a private medical insurance policy, an EHIC card or an S1, S2 or S3 form.

**Original documents must not be sent to licensing authorities.** If the document copied is a passport, a copy of the following pages should be provided:-

- (i) any page containing the holder's personal details including nationality;
- (ii) any page containing the holder's photograph;
- (iii) any page containing the holder's signature;
- (iv) any page containing the date of expiry; and
- (v) any page containing information indicating the holder has permission to enter or remain in the UK and is permitted to work.

If the document is not a passport, a copy of the whole document should be provided.

Your right to work will be checked as part of your licensing application and this could involve us checking your immigration status with the Home Office. We may otherwise share information with the Home Office. Your licence application will not be determined until you have complied with this guidance.

---

## **Section 20 of 21**

---

### **NOTES ON REGULATED ENTERTAINMENT**

---

*Continued from previous page...*

In terms of specific **regulated entertainments** please note that:

- Plays: no licence is required for performances between 08:00 and 23.00 on any day, provided that the audience does not exceed 500.
- Films: no licence is required for 'not-for-profit' film exhibition held in community premises between 08.00 and 23.00 on any day provided that the audience does not exceed 500 and the organiser (a) gets consent to the screening from a person who is responsible for the premises; and (b) ensures that each such screening abides by age classification ratings.
- Indoor sporting events: no licence is required for performances between 08.00 and 23.00 on any day, provided that the audience does not exceed 1000.
- Boxing or Wrestling Entertainment: no licence is required for a contest, exhibition or display of Greco-Roman wrestling, or freestyle wrestling between 08.00 and 23.00 on any day, provided that the audience does not exceed 1000. Combined fighting sports – defined as a contest, exhibition or display which combines boxing or wrestling with one or more martial arts – are licensable as a boxing or wrestling entertainment rather than an indoor sporting event.
- Live music: no licence permission is required for:
  - o a performance of unamplified live music between 08.00 and 23.00 on any day, on any premises.
  - o a performance of amplified live music between 08.00 and 23.00 on any day on premises authorised to sell alcohol for consumption on those premises, provided that the audience does not exceed 500.
  - o a performance of amplified live music between 08.00 and 23.00 on any day, in a workplace that is not licensed to sell alcohol on those premises, provided that the audience does not exceed 500.
  - o a performance of amplified live music between 08.00 and 23.00 on any day, in a church hall, village hall, community hall, or other similar community premises, that is not licensed by a premises licence to sell alcohol, provided that (a) the audience does not exceed 500, and (b) the organiser gets consent for the performance from a person who is responsible for the premises.
  - o a performance of amplified live music between 08.00 and 23.00 on any day, at the non-residential premises of (i) a local authority, or (ii) a school, or (iii) a hospital, provided that (a) the audience does not exceed 500, and (b) the organiser gets consent for the performance on the relevant premises from: (i) the local authority concerned, or (ii) the school or (iii) the health care provider for the hospital.
- Recorded Music: no licence permission is required for:
  - o any playing of recorded music between 08.00 and 23.00 on any day on premises authorised to sell alcohol for consumption on those premises, provided that the audience does not exceed 500.
  - o any playing of recorded music between 08.00 and 23.00 on any day, in a church hall, village hall, community hall, or other similar community premises, that is not licensed by a premises licence to sell alcohol, provided that (a) the audience does not exceed 500, and (b) the organiser gets consent for the performance from a person who is responsible for the premises.
  - o any playing of recorded music between 08.00 and 23.00 on any day, at the non-residential premises of (i) a local authority, or (ii) a school, or (iii) a hospital, provided that (a) the audience does not exceed 500, and (b) the organiser gets consent for the performance on the relevant premises from: (i) the local authority concerned, or (ii) the school proprietor or (iii) the health care provider for the hospital.



**Continued from previous page...**

- Dance: no licence is required for performances between 08.00 and 23.00 on any day, provided that the audience does not exceed 500. However, a performance which amounts to adult entertainment remains licensable.
- Cross activity exemptions: no licence is required between 08.00 and 23.00 on any day, with no limit on audience size for:
  - o any entertainment taking place on the premises of the local authority where the entertainment is provided by or on behalf of the local authority;
  - o any entertainment taking place on the hospital premises of the health care provider where the entertainment is provided by or on behalf of the health care provider;
  - o any entertainment taking place on the premises of the school where the entertainment is provided by or on behalf of the school proprietor; and
  - o any entertainment (excluding films and a boxing or wrestling entertainment) taking place at a travelling circus, provided that (a) it takes place within a moveable structure that accommodates the audience, and (b) that the travelling circus has not been located on the same site for more than 28 consecutive days.

**Section 21 of 21**

**PAYMENT DETAILS**

This fee must be paid to the authority. If you complete the application online, you must pay it by debit or credit card.

Premises Licence Fees are determined by the non-domestic rateable value of the premises.

To find out a premises non domestic rateable value go to the Valuation Office Agency site at [http://www.voa.gov.uk/business\\_rates/index.htm](http://www.voa.gov.uk/business_rates/index.htm)

Band A - No RV to £4300 £100.00

Band B - £4301 to £33000 £190.00

Band C - £33001 to £87000 £315.00

Band D - £87001 to £125000 £450.00\*

Band E - £125001 and over £635.00\*

\*If the premises rateable value is in Bands D or E and the premises is primarily used for the consumption of alcohol on the premises then you are required to pay a higher fee.

Band D - £87001 to £125000 £900.00

Band E - £125001 and over £1,905.00

There is an exemption from the payment of fees in relation to the provision of regulated entertainment at church halls, chapel halls or premises of a similar nature, village halls, parish or community halls, or other premises of a similar nature. The costs associated with these licences will be met by central Government. If, however, the licence also authorises the use of the premises for the supply of alcohol or the provision of late night refreshment, a fee will be required.

Schools and sixth form colleges are exempt from the fees associated with the authorisation of regulated entertainment where the entertainment is provided by and at the school or college and for the purposes of the school or college.

If you operate a large event you are subject to ADDITIONAL fees based upon the number in attendance at any one time.

Capacity 5000-9999 £1,000.00

Capacity 10000 -14999 £2,000.00

Capacity 15000-19999 £4,000.00

Capacity 20000-29999 £8,000.00

Capacity 30000-39999 £16,000.00

Capacity 40000-49999 £24,000.00

Capacity 50000-59999 £32,000.00

Capacity 60000-69999 £40,000.00

Capacity 70000-79999 £48,000.00

Capacity 80000-89999 £56,000.00

Capacity 90000 and over £64,000.00

\* Fee amount (£)

190.00

**ATTACHMENTS**

**AUTHORITY POSTAL ADDRESS**

Continued from previous page...

### Address

Building number or name

Street

District

City or town

County or administrative area

Postcode

Country

United Kingdom

### DECLARATION

- \* I/we understand it is an offence, liable on conviction to a fine up to level 5 on the standard scale, under section 158 of the licensing act 2003, to make a false statement in or in connection with this application.

#### You must check the box for this declaration

- [Applicable to individual applicants only, including those in a partnership which is not a limited liability partnership] I understand I am not entitled to be issued with a licence if I do not have the entitlement to live and work in the UK (or if I am subject to a condition preventing me from doing work relating to the carrying on of a licensable activity) and that my licence will become invalid if I cease to be entitled to live and work in the UK (please read guidance note 15).

#### You must check the box for this declaration

- The DPS named in this application form is entitled to work in the UK (and is not subject to conditions preventing him or her from doing work relating to a licensable activity) and I have seen a copy of his or her proof of entitlement to work, if appropriate (please see note 15)

Ticking this box indicates you have read and understood the above declaration

This section should be completed by the applicant, unless you answered "Yes" to the question "Are you an agent acting on behalf of the applicant?"

\* Full name

\* Capacity

Date (dd/mm/yyyy)

Add another signatory

Once you're finished you need to do the following:

1. Save this form to your computer by clicking file/save as...
2. Go back to <https://www.gov.uk/apply-for-a-licence/premises-licence/herefordshire/apply-1> to upload this file and continue with your application.

Don't forget to make sure you have all your supporting documentation to hand.



*Continued from previous page...*

**IT IS AN OFFENCE LIABLE TO SUMMARY CONVICTION TO A FINE OF ANY AMOUNT UNDER SECTION 158 OF THE LICENSING ACT 2003, TO MAKE A FALSE STATEMENT IN OR IN CONNECTION WITH THIS APPLICATION**

**IT IS AN OFFENCE UNDER SECTION 24B OF THE IMMIGRATION ACT 1971 FOR A PERSON TO WORK WHEN THEY KNOW, OR HAVE REASONABLE CAUSE TO BELIEVE, THAT THEY ARE DISQUALIFIED FROM DOING SO BY REASON OF THEIR IMMIGRATION STATUS. THOSE WHO EMPLOY AN ADULT WITHOUT LEAVE OR WHO IS SUBJECT TO CONDITIONS AS TO EMPLOYMENT WILL BE LIABLE TO A CIVIL PENALTY UNDER SECTION 15 OF THE IMMIGRATION, ASYLUM AND NATIONALITY ACT 2006 AND PURSUANT TO SECTION 21 OF THE SAME ACT, WILL BE COMMITTING AN OFFENCE WHERE THEY DO SO IN THE KNOWLEDGE, OR WITH REASONABLE CAUSE TO BELIEVE, THAT THE EMPLOYEE IS DISQUALIFIED**



**Form of consent given by the person whom the applicant wishes to be the premises supervisor**

I, **Karl Hawkins**.*[insert first names and surname of prospective premises supervisor]* hereby consents to being named as the premises supervisor in a new licence granted under paragraph 4 of Schedule 8 to the Licensing Act 2003 to

**Karl Hawkins**.*[insert full name of applicant]* where the holder of the licence has consented to the application being made by the applicant for **Forge Filling Station, Wormbridge, Hereford, HR2 9DH**. *[Insert name and address of the proposed licensed premises]* if that application is successful.

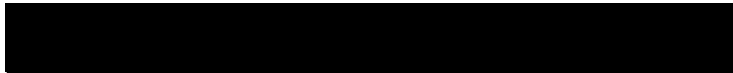

Dated 28.09.18

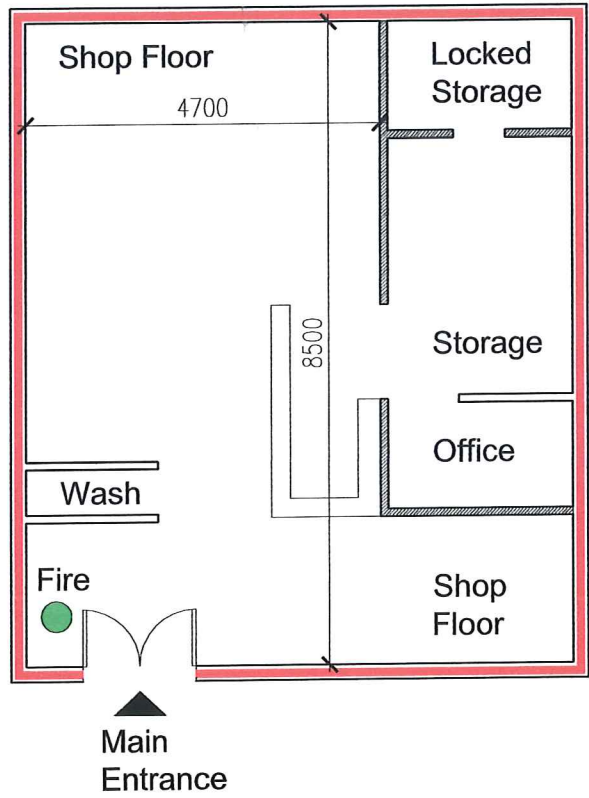

**Floor Plan**  
1:100 Scale

- Licensable Activity
- Solid internal wall
- Fire
  - 1No Powder
  - 1No Foam
  - 1No Fire Bucket

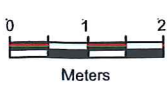

|  |  |  |
|--|--|--|
| <b>GriffithsDesign</b><br>Architectural Technologists. |  | Tel: 07969446621<br>Email: griffithsdesign@outlook.com |
| <b>Client</b>  | Mr K. Hawkins  |  |
| <b>Project</b>   | Forge Filling Station,<br>Wormbridge,<br>Herefordshire,<br>HR2 9DH |  |
| <b>Drawing</b>   | Floor Plan for Premises Licence                                    |  |
| <b>Date</b>  | October 2018   | <b>Scale</b> 1:100 @ A4                                |
| <b>Drawn by</b>  | JG   | <b>Drawing No</b><br>[BD] 01.                          |
| <b>Checked by</b>                                      | ***  |  |
| <b>Revision</b>  |  |  |